

PART SITE PLAN EXISTING SERVICES
1:400 SCALE

LEGEND

- Existing Underground Electrical Services UNO
- - - Existing Sewer Line 50mm DIA. POLY PRESSURISED
- - - Existing Sewer Line 100mm DIA. GRAVITY FLOW
- - - Existing U/G Water Supply Lines

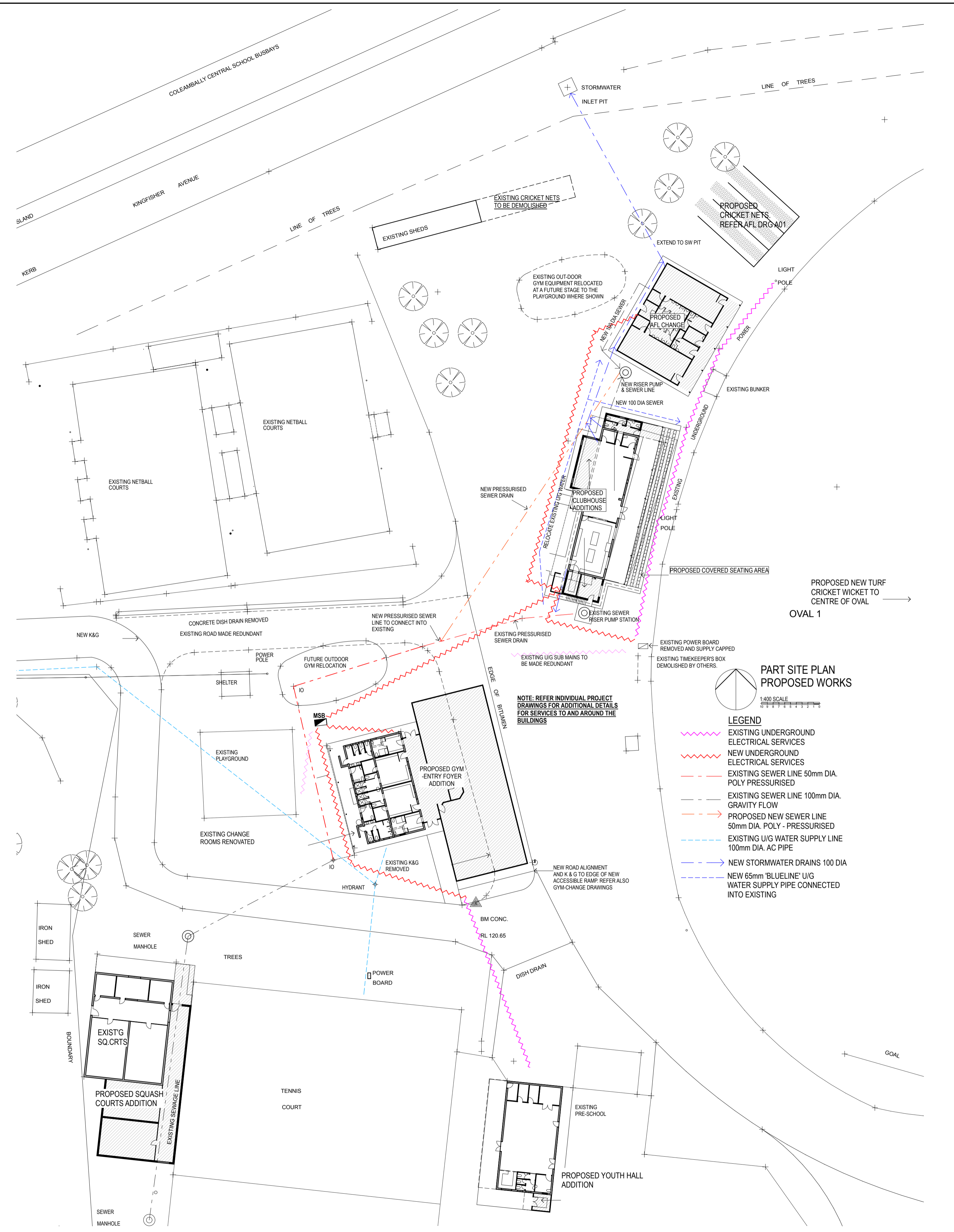

PART SITE PLAN PROPOSED WORKS
1:400 SCALE

LEGEND

- Existing Underground Electrical Services
- - - New Underground Electrical Services
- - - Existing Sewer Line 50mm DIA. POLY PRESSURISED
- - - Existing Sewer Line 100mm DIA. GRAVITY FLOW
- - - Proposed New Sewer Line 50mm DIA. POLY - PRESSURISED
- - - Existing U/G Water Supply Line 100mm DIA. AC PIPE
- - - New Stormwater Drains 100 DIA.
- - - New 65mm 'BLUELINE' U/G Water Supply Pipe Connected into Existing

CONSULTANTS	REVISION NUMBER	REVISION DATE	REVISION DESCRIPTION
	FOR TENDER		

ARCHITECT	PROJECT	TITLE	JOB NUMBER:	DRAWING NUMBER:	
 STEVEN MURRAY ARCHITECT Registration No. 4450 35 BOONAH STREET, GRIFFITH NSW 2680 PH/FAX: (02) 6964 7798 Email: stevenmurray54@gmail.com www.stevenmurrayarchitecture.com	PROPOSED DEVELOPMENT OF NO.1 SPORTS OVAL PRECINCT, COLEAMBALLY NSW	SITE PLANS	DATE:	SCALE: 1:400 ON A1 1:800 ON A3	PAGE SIZE:
			MURRUMBIDGE COUNCIL	MAR. 2020	SM

CLIENT	DESIGNED:	DRAWN:	CHECKED:
MURRUMBIDGE COUNCIL	DOCHERTY SURVEYOR/ISM	SM	SM